

**Specifications:**

Contact Resistance 30m $\Omega$  max at DC100mA  
 Insulator resistance 100M $\Omega$  min at DC50V  
 Current Rating 1A

**Dielectric Withstanding**

Voltage AC500V For 1 minute  
 Operating Temperature -55 C--+105 C  
 Contact: Brass or phosphor bronze  
 Housing PBT & 30% Glass Fiber (UL 94V-0)

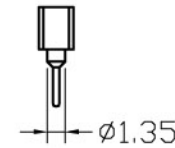
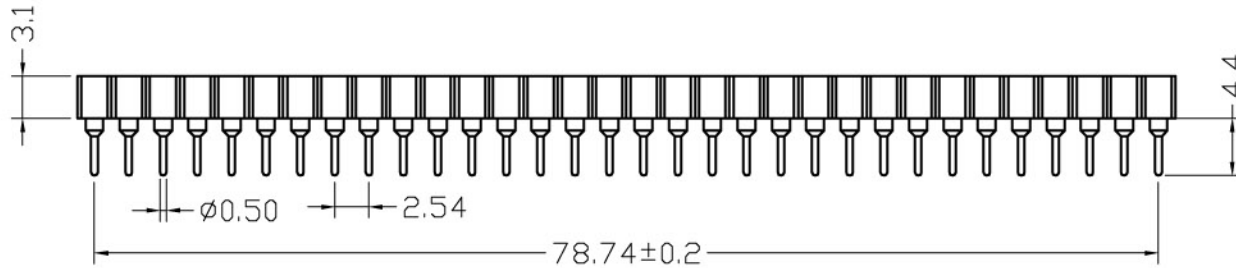
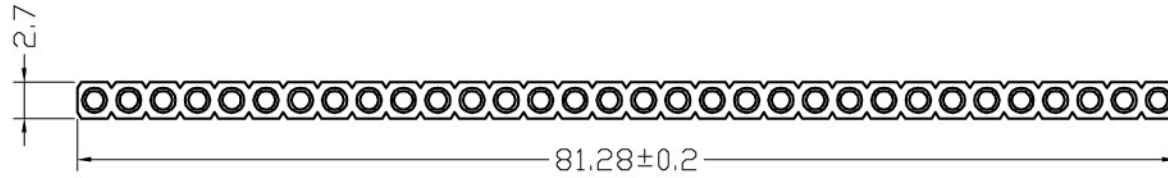

**要求:**

1. 塑料件无裂痕。
2. 整排针成一直线，相邻针之间相互平行。

设计/Designed by	绘图/Drawing by	审核/Checked by	批准/Approved by	未注公差 General Tolerance	
				x. ±0.2	x." ±2'
		图名/Title	文件编号/File No.	.x ±0.1	.x' ±1'
		<b>131-S32</b> (进口PIN)	页序/Sheet	.xx ±0.05	.xx' ±0.5'
		备注/Remark		.xxx ±0.01	
				单位/Units: mm	