

PCB LAYOUT/TOP VIEW

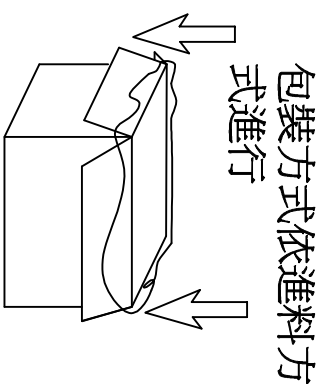
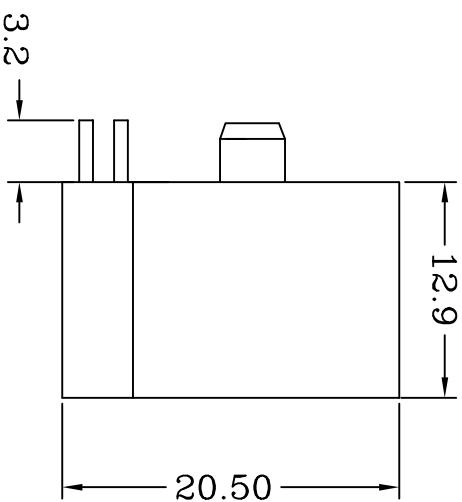
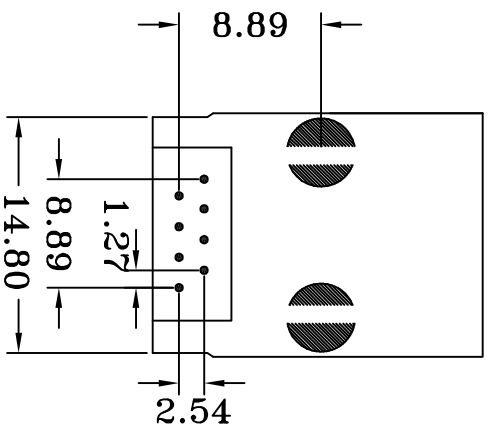
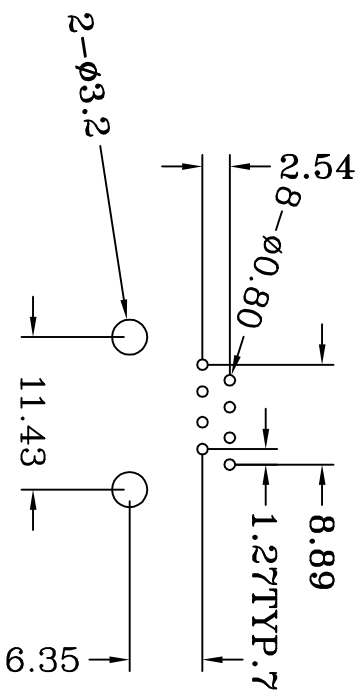

ITEM NO	ITEM	DESCRIPTION	UNIT	QTY
C	GOLD PLATING	SELECTIVE GOLD PLATING 6U"	PCS	8
B	HOUSING	STANDARD MATERIAL GLASS FILLED POLYESTER UL 94V-0 STANDARD BLACK BINARY KEY	PCS	1
A	CONTACT	0.46MM DIAMETER PHOEPHOR BRONZE GOLD PLATING OVER NICKEL 90°	PCS	1

CHECKED	DRAW
INSPECTED	CUS.PART NO.
APPROVED	CUSTOMER
TITLE	TL321BX882UXY/FT2188
DRAWING NO.	E0276
REV	B

TOLERANCE GENERALES					
PLASTIC DIMENSION	X	X.X	X.XX	CABLE LENGTH	X
tolerance(±)	1	0.5	0.20	tolerance(±)	2%

JERRY	ECN.NO.
TF2188	-
NO.	TL321
DATE	04/11/27