

| Rev. | Date | Description |
|------|------------|----------------|
| A | 2005/02/02 | New Drawing |
| B | 2006/09/12 | Modify Drawing |

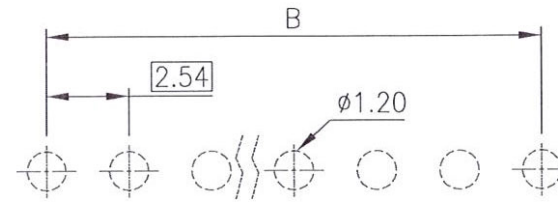

PCB Layout
(Top View)

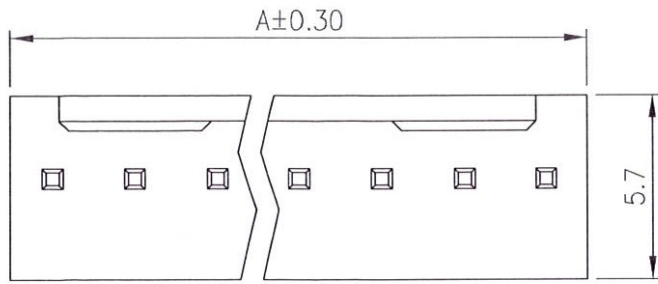
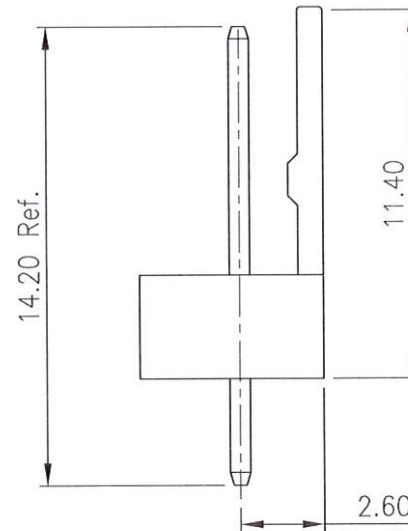
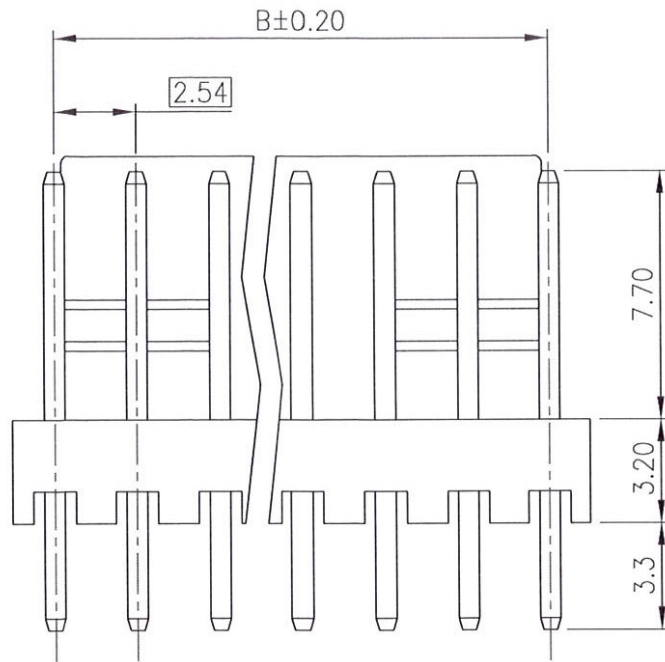

| Order Information | Dimensions | | |
|-------------------|------------|-------|-------|
| | Pos. | A | B |
| 240301V02 | 02 | 5.08 | 2.54 |
| 240301V03 | 03 | 7.62 | 5.08 |
| 240301V04 | 04 | 10.16 | 7.62 |
| 240301V05 | 05 | 12.70 | 10.16 |
| 240301V06 | 06 | 15.24 | 12.70 |
| 240301V07 | 07 | 17.78 | 15.24 |
| 240301V08 | 08 | 20.32 | 17.78 |
| 240301V09 | 09 | 22.86 | 20.32 |
| 240301V10 | 10 | 25.40 | 22.86 |
| 240301V11 | 11 | 27.94 | 25.40 |
| 240301V12 | 12 | 30.48 | 27.94 |
| 240301V13 | 13 | 33.02 | 30.48 |
| 240301V14 | 14 | 35.56 | 33.02 |
| 240301V15 | 15 | 38.10 | 35.56 |

| Material and Finish | Electrical Characteristics | Mechanical Characteristics |
|--|---|---|
| 1. Housing: Polyamide (UL94V-2), Natural. 2. Terminal: Sq. 0.64mm Brass, Tin Plating. | 1. Current Rating: 3.0 Amp. Max.. 2. Dielectric Withstand Voltage: 1000V AC RMS for 60Seconds. 3. Insulation Resistance: 1000M Ohms Min. at 1000V DC. | 1. Operating Temperature: -25°C ~ +85°C |

Tolerance: 0.0 ±0.30
 0.00 ±0.20
 0.000 ±0.10
 Scale: 1:1 mm
 Drawing No: HD240301V
 Title: 2.54mm Wafer Connector PCB Mount Vertical