



## PLANETARY GEAR

- REDUCTORES PLANETARIOS: combinables con la serie 162. Ver sección especial en catálogo.
- PLANETARY GEARS: combinable with 162 series. See special section in catalogue.
- REDUCTEURS PLANETAIRES: combinables avec la série 162. Consultez section spécial du catalogue.
- PLANETENGETRIEBE: Mit der Reihe 162 kombinierbar. Sehen Sie Sonderabschnitt im Katalog.

A



B

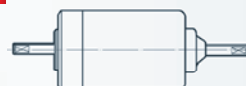

REFERENCIA REFERENCE NUMBER REFERENZNUMMERN	TENSION NOMINAL NOMINAL VOLTAGE TENSION NOMINALE NENNSPANNUNG	PAR NOMINAL NOMINAL TORQUE COUPLE NOMINAL DREHMOMENT NOMINAL	VELOCIDAD NOMINAL NOMINAL SPEED VITESSE NOMINALE GESCHWINDIGKEIT NOMINAL	CORRIENTE NOMINAL NOMINAL CURRENT COURANT NOMINAL NOMINALSTROM	PAR DE ARRANQUE STARTING TORQUE COUPLE DE DÉMARRAGE ANZUGSDREHMOMENT	CORRIENTE DE ARRANQUE STARTING CURRENT COURANT DE DÉMARRAGE ANLAUFSTROM	EJE SHAFT ARBRE WELLE	CONEXIONES CONNECTIONS CONNEXIONS ANSCHLUSSART	ESQUEMA ELÉCTRICO WIRING DIAGRAM SCHEMA ELECTRIQUE SCHALTBIKD	PESO APROXIMADO APPROXIMATE WEIGHT POIDS APPROXIMATIF GEWICHT (ca.)	GRADO DE ESTANQUEIDAD WATERTIGHTNESS ÉTANCHÉITE FEUCHTIGKEITSSCHUTZKLASSE	DISEÑO: A/B DESIGN: A/B DESSIN: A/B ABBILDUNG: A/B	CURVA CURVE COURBE KURVE
	Un (V)	Mn (N.m./lbf.in)	nn (r.p.m.)	In (A)	Ma (N.m./lbf.in)	Ia (A)				P (kg/lb.t)	IP		
162.4101.20.00	12	0.18 / 1.59	2800	7.5	1.0 / 8.85	33	E2	C2	EE2	1.1 / 2.95	IP53	a	32
162.4101.30.00	24	0.20 / 1.77	3000	4	1.0 / 8.85	18	E2	C2	EE2	1.1 / 2.95	IP53	a	33
162.4102.20.00	12	0.20 / 1.77	2000	6	1.0 / 8.85	24	E2	C3	EE2	1.1 / 2.95	IP53	a	34
162.4102.30.00	24	0.20 / 1.77	2000	3	1.0 / 8.85	12	E2	C3	EE2	1.1 / 2.95	IP53	a	34
162.4106.20.00	12	0.18 / 1.59	2800	7.5	1.0 / 8.85	33	E4	C2	EE2	1.1 / 2.95	IP53	a	32
162.4106.30.00	24	0.20 / 1.77	3000	4	1.0 / 8.85	18	E4	C2	EE2	1.1 / 2.95	IP53	a	33
162.4107.30.00E	24	0.20 / 1.77	2000	3	1.0 / 8.85	12	E5	C5	F3	1.1 / 2.95	IP53	a	34
162.4108.20.00	12	0.18 / 1.59	1500	5	0.8 / 7.08	17	E2	C3	EE2	1.1 / 2.95	IP53	a	35
162.4108.30.00	24	0.18 / 1.59	1500	2.5	0.8 / 7.08	8.5	E2	C3	EE2	1.1 / 2.95	IP53	a	35
162.4109.30.00	24	0.18 / 1.59	1500	2.5	0.8 / 7.08	8.5	E38	C35	EE3	1.1 / 2.95	IP53	a	35
162.4109.50.00	48	0.18 / 1.59	1500	1,3	0.8 / 7.08	4,5	E38	C35	EE3	1.1 / 2.95	IP53	a	35
162.4113.30.00	24	0.12 / 1.06	3000	2.5	1.0 / 8.85	15	E3	C4	F3	1.1 / 2.95	IP40	a	36
162.4116.30.00	24	0.20 / 1.77	3000	4	1.0 / 8.85	18	E58/E57	C2	EE2	1.1 / 2.95	IP40	b	33

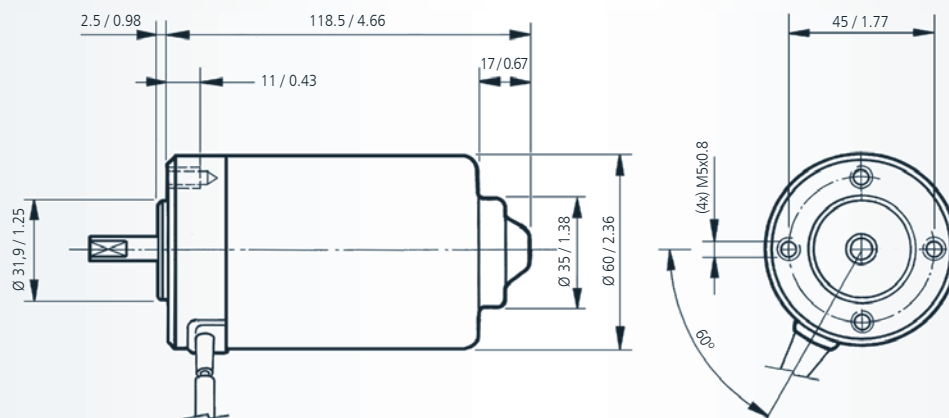

EJE - SHAFT - ARBRE - WELLE

CURVAS - CURVES - COURBES - KURVEN

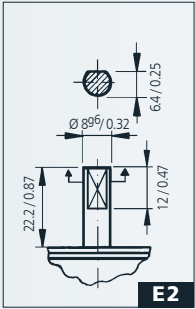

**E2**

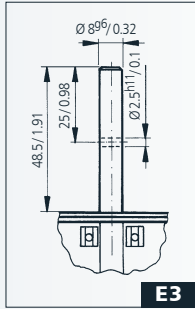

**E3**

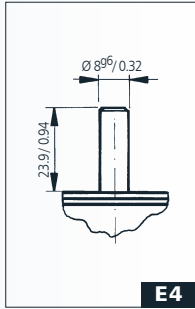

**E4**

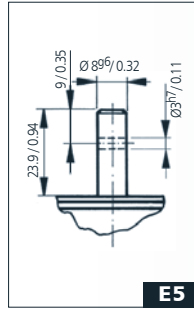

**E5**

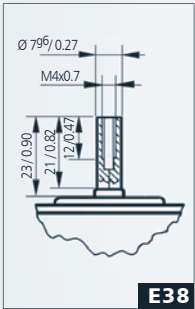

**E38**

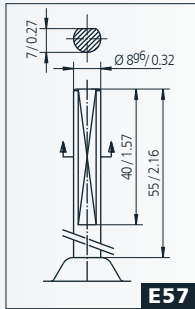

**E57**

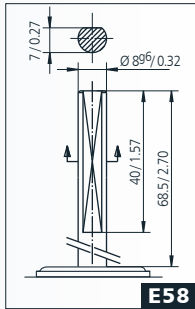

**E58**

CONEXIONES - CONNECTIONS  
CONNEXIONS - ANSCHLUSSART

ESQUEMA ELÉCTRICO - WIRING DIAGRAM  
SCHEMA ÉLECTRIQUE - SCHALTBILD

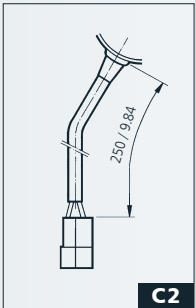

**C2**

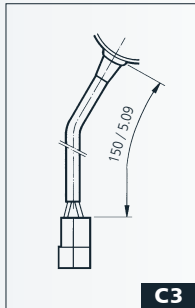

**C3**

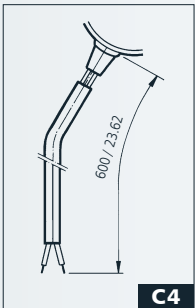

**C4**

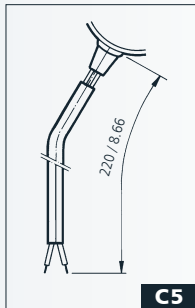

**C5**

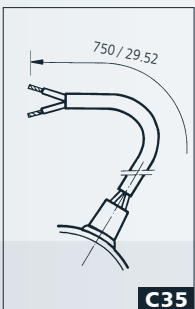

**C35**

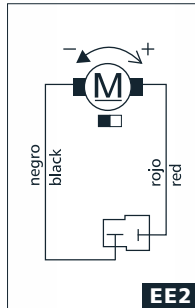

**EE2**

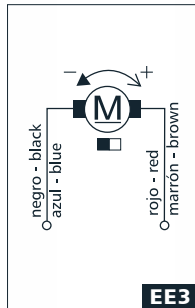

**EE3**

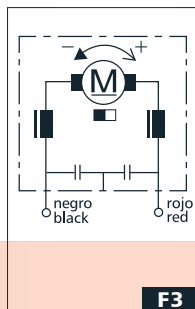

**F3**

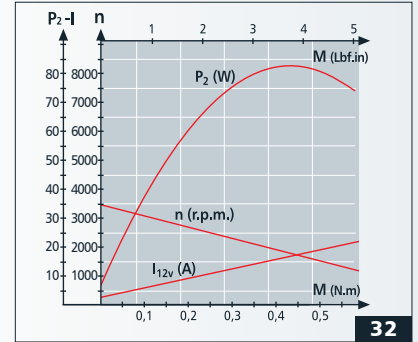

**32**

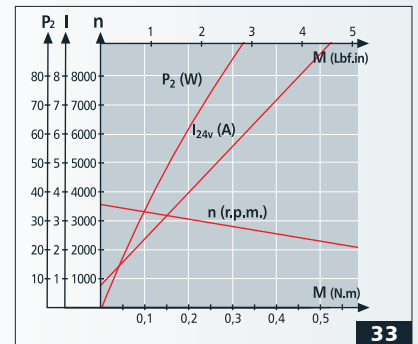

**33**

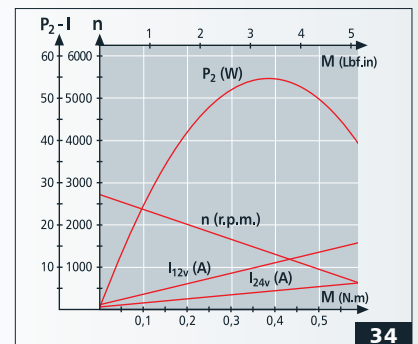

**34**

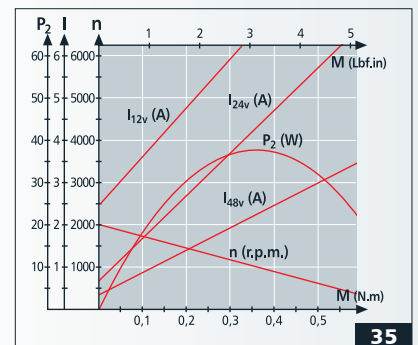

**35**

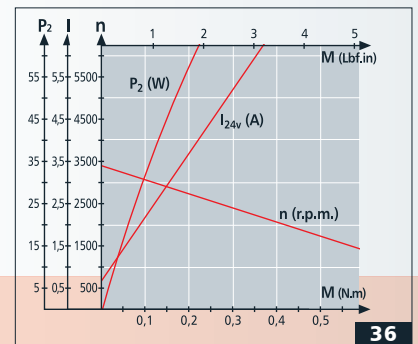

**36**