



323-937 | 950 | 974

**Features**

- Low current requirements
- Excellent character appearance
- High light output
- Reliable and rugged
- IC. compatible

**Recommended Maximum Ratings**

Reverse voltage	5.0V
Reverse voltage (GaAsP Red)	3.0V
D.C. forward current	30mA
Pulse current (10% duty cycle 0.1ms pulse width)	100mA
Operating temperature range	-25°C to +85°C
Storage temperature range	-25°C to +100°C
Lead soldering temperature (1.6mm from body)	+260°C for 5 secs.

(T<sub>a</sub>=25°C)

**Electrical & Optical Characteristics**

Part Number	L.E.D. Chip		Face colour		Peak Wavelength @20mA(nm)	Forward Voltage @20mA(V)		Luminous Intensity @10mA(mcd)	
	Material	Emitting Colour	Surface	Segment or dot		TYP.	MAX.	MIN.	TYP.
G 10 000 G W 1	GaAsP	Red	Grey	White	655	1.7	2.0	0.3	0.6
G 10 000 G W 2	GaP	Green	Grey	White	567	2.1	3.0	1.4	3.4
G 10 000 G W 3	GaAsP on GaP	Yellow	Grey	White	585	2.1	3.0	1.1	2.8
G 10 000 G W 4	GaAsP on GaP	Orange	Grey	White	635	2.1	3.0	1.6	3.9
G 10 000 G W 5	GaP	Red	Grey	White	700	2.1	3.0	0.4	0.9
G 10 000 R R R	GaAsP on GaP	Hi-Eff. Red	Red	Red	635	2.1	3.0	1.6	3.9

(T<sub>a</sub>=25°C)

**Package Dimensions & Pin Functions**

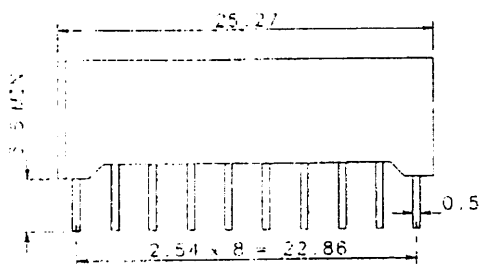
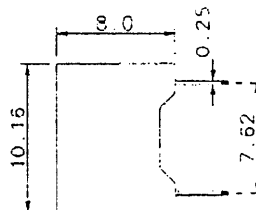
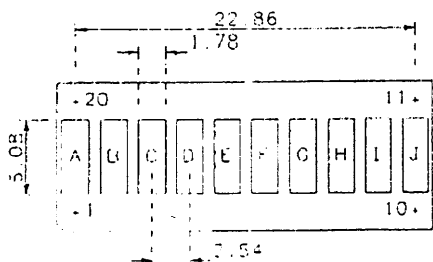

**G 10 000 e f h**

Pin	Function	Pin	Function
1	A Anode	11	J Cathode
2	B Anode	12	I Cathode
3	C Anode	13	H Cathode
4	D Anode	14	G Cathode
5	E Anode	15	F Cathode
6	F Anode	16	E Cathode
7	G Anode	17	D Cathode
8	H Anode	18	C Cathode
9	I Anode	19	B Cathode
10	J Anode	20	A Cathode

1. All dimension are in mm, tolerance is ±0.25mm unless otherwise stated.  
 2. The slope angle of any pin may be ±5.0° maximum.

Our ref: G10000RRR

Description: LED light bar 10 segment Hi - Eff red with Red Face, Red Segment

As requested please find data sheet attached and also copy will be posted this evening to you, I will also include copies of our catalogues.

Please note that in all cases these products need to be wired in parallel with individual current limiting resistors else there is a tendency for each segment to vary in brightness.

**Part Number / Order Code**

**Factory Production Code**

G10000GW1  
G10000GW2  
G10000GW3  
G10000GW4  
G10000GW5  
G10000RRR

LL10000R  
LL10000G  
LL10000Y  
LL10000O  
LL10000P  
LL10000HR