

MODEL DESIGNATION

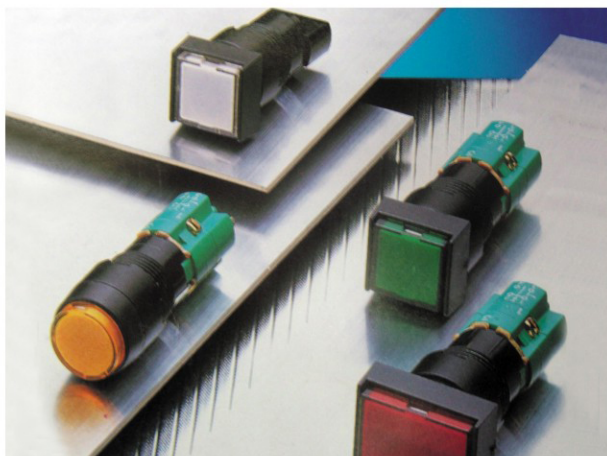
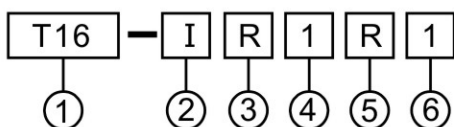

Designation	Signal	Description	
1. Mounting Hole	TN16	16m/m Series	
2. Type	I	Illuminated Push Button(Alternate)	
	B	Illuminated Push Button(Momentary)	
	P	Pilot Lamp	
	G	Switch Guard	
	W	Sealing Cap	
3. Shape	R	Round	
	S	Square	
	L	Rectangular	
4. Voltage	1	110V AC	
	2	220V AC	
	5	6VAC/DC	
	6	18VAC/DC	
	7	24VAC/DC	
	8	30VAC/DC	
	9	12VAC/DC	
	5. Lens Color	R	Red
		G	Green
O		Orange	
W		White	
B		Blue	
6. Contact Blocks	1	1a1b	
	2	2a2b	
	3	3a3b	
	4	4a4b	

CHARACTERISTICS

Contact resistance	50mΩ min.
Insulation resistance	100MΩ min. (at 500VDC)
Dielectric strength	1500VAC, 50/60Hz for 1minute
Ambient temperature	operating: -20°C ~80°C
Humidity	95% RH max.
Operation force	150 g
Service life	Mechanically: 1,000,000 operations min. Electrically: 100,000 operations min.
Weight	10 gr(1a1b)
	15 gr(4a4b)

RATING

Rated insulation voltage		250VAC	125VAC	Contact	Length
Rated continuous current(A)		3A	5A		
Rated operating current(A)					
AC			DC		
Voltage	AC13	AC12	Voltage	DC13	DC12
110V	0.7A	1A	12V	0.7A	1A
220V	0.5A	0.5A	24V	0.7A	1A
				3a3b	57.5mm
				4a4b	65.5mm

AC13/DC13: Inductive load; AC12/DC12: Resistivw load

PANEL MOUNTING

● (R, S TYPE)

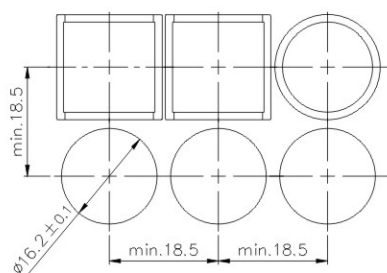

● (L TYPE)

