

## Header

### Top entry type

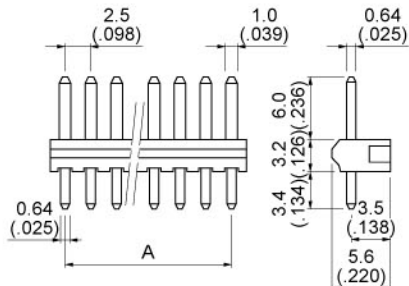

### Side entry type

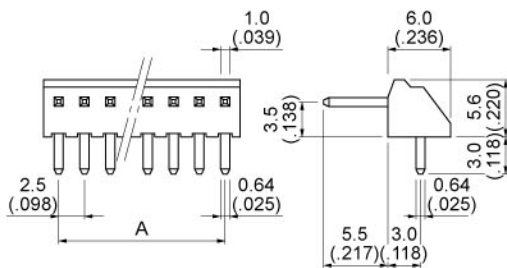

### Bottom entry type

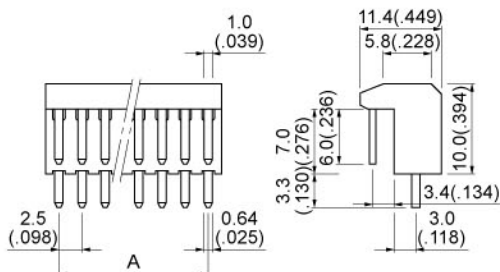

Circuits	Model No.			Dimensions A mm(in.)	Q'ty / box		
	Top entry type	Side entry type	Bottom entry type		Top entry type	Side entry type	Bottom entry type
2	B 2P-SHF-1AA	BS 2P-SHF-1AA	BE 2P-SHF-1AA	2.5(.098)	1,000	2,000	250
3	B 3P-SHF-1AA	BS 3P-SHF-1AA	BE 3P-SHF-1AA	5.0(.197)	1,000	1,000	250
4	B 4P-SHF-1AA	BS 4P-SHF-1AA	BE 4P-SHF-1AA	7.5(.295)	1,000	1,000	250
5	B 5P-SHF-1AA	BS 5P-SHF-1AA	BE 5P-SHF-1AA	10.0(.394)	1,000	500	250
6	B 6P-SHF-1AA	BS 6P-SHF-1AA	BE 6P-SHF-1AA	12.5(.492)	1,000	500	150
7	B 7P-SHF-1AA	BS 7P-SHF-1AA	BE 7P-SHF-1AA	15.0(.591)	500	500	150
8	B 8P-SHF-1AA	BS 8P-SHF-1AA	BE 8P-SHF-1AA	17.5(.689)	500	500	150
9	B 9P-SHF-1AA	BS 9P-SHF-1AA	BE 9P-SHF-1AA	20.0(.787)	500	500	150
10	B10P-SHF-1AA	BS10P-SHF-1AA	BE10P-SHF-1AA	22.5(.886)	500	250	100
11	B11P-SHF-1AA	BS11P-SHF-1AA	BE11P-SHF-1AA	25.0(.984)	500	250	100
12	B12P-SHF-1AA	BS12P-SHF-1AA	BE12P-SHF-1AA	27.5(1.083)	250	200	100
13	B13P-SHF-1AA	BS13P-SHF-1AA	BE13P-SHF-1AA	30.0(1.181)	250	200	100
14	B14P-SHF-1AA	BS14P-SHF-1AA	BE14P-SHF-1AA	32.5(1.280)	250	200	50
15	B15P-SHF-1AA	BS15P-SHF-1AA	BE15P-SHF-1AA	35.0(1.378)	250	200	50
16	B16P-SHF-1AA	BS16P-SHF-1AA	—	37.5(1.476)	250	200	—
18	B18P-SHF-1AA	BS18P-SHF-1AA	—	42.5(1.673)	250	200	—
20	B20P-SHF-1AA	BS20P-SHF-1AA	—	47.5(1.870)	250	200	—
21	B21P-SHF-1AA	BS21P-SHF-1AA	—	50.0(1.969)	250	200	—
22	B22P-SHF-1AA	BS22P-SHF-1AA	—	52.5(2.067)	250	200	—
24	B24P-SHF-1AA	BS24P-SHF-1AA	—	57.5(2.264)	250	200	—
25	B25P-SHF-1AA	BS25P-SHF-1AA	—	60.0(2.362)	250	200	—

### Material and Finish

Post: Brass copper-undercoated, tin/lead-plated  
 Wafer: Nylon 66, UL94V-0, natural (white) for the top and side entry types  
 Nylon 6, UL94V-0, natural (white) for the bottom entry type

<For reference> As the color identification, the following alphabet shall be put in the underlined part.  
 For availability, delivery and minimum order quantity, contact JST.

ex. B3P-SHF-1AA-oo

(blank)...natural (white)

BK...black R...red TR...tomato red E...blue M...green

O...orange N...brown